



COPPER

TEST KIT

Model EC-20R • Code 6897-R

COPPER TEST KIT

Model EC-20R • Code 6897-R

***Hazardous Materials:** Read MSDS and product label before use.

1.

Fill two tubes (0106) to the 10 mL line with sample water. Place tubes in cap holders as shown.

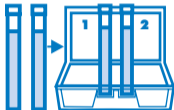

2.

Add 5 drops of ***Copper 1** to **Tube 1**. Cap and mix. A yellow-brown color indicates the presence of copper. Place **Tube 1** in holder. Remove cap.



3.

Add 1 drop of **Copper 2** to **Tube 2**. Cap and mix. Place **Tube 2** in holder. Remove cap. Look down through the tubes. Compare the color intensity in **Tube 1** and **Tube 2**. Continue adding **Copper 2** to **Tube 2**, one drop at a time. Mix and compare the color intensity after each drop. Count the number of drops. **Stop** when the color intensity is equal in both tubes.

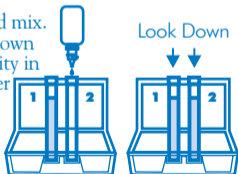

4.

Read result in ppm copper from chart.

# of drops in tube 2	Copper ppm
1	= 0.05
2	= 0.10
3	= 0.15
4	= 0.20
5	= 0.25
6	= 0.30
7	= 0.35
8	= 0.40
9	= 0.45
10	= 0.50

Exceeding 10 drops is not recommended