

LAKEWOOD INSTRUMENTS

MODEL 1575e

WATER TREATMENT CONTROLLER



The Model 1575e uses the latest in microprocessor capability, giving the user a high level of application flexibility. A large illuminated graphics screen, multiple inputs, and very easy setup characterize this new technology. The Model 1575e is ETL approved.

PART NUMBER 1229242 SHOWN

Cooling Tower Water Treatment Controller, Including Flow Switch Plumbing And Conductivity Sensor On A Mounting Plate

FEATURES

- Removable power cord and receptacles for simple conduit installations.
- Scheduled feed, which can use three relays for biocides or other chemicals.
- Two (2) water meter inputs, two (2) drum switch inputs, conductivity input, a flow switch input, a 4-20 mA output, and a 4-20 mA input are all standard features.
- The 4-20 mA input can be used with a transmitter for one of the following: remote conductivity, makeup conductivity, pH, ORP, percent, pressure, milliamps, flow rates, or traced chemistry control. This transmitter can be added in the field.
- Designed with a single circuit board for better reliability and lower cost.
- Large open shallow enclosure for easy wiring.
- Ball valve delay feature allows accurate control of motorized ball valves.
- Heavy-duty stainless steel domed numeric keypad and illuminated graphical display allow for quick and easy programming. Steel domed switches improve the tactile sensing and life expectancy of the keypad.
- LED indicators for power, alarm and relay status.

BENEFITS

- Easy to program with the Lakewood plain English, intuitive, and user friendly menu interface.
- Controller can be used in boiler, cooling tower, or condensate applications when used with the appropriate conductivity sensor.
- Single circuit board design improves reliability.
- No add-on options. 4-20 mA output and feed schedule clock features are standard.

SPECIFICATIONS

Conductivity range	50-10,000 μ S
Conductivity sensor	2 electrode
Conductivity Resolution	$\pm 10 \mu$ S (conductivity <5000 μ S) $\pm 100 \mu$ S (conductivity > 5000 μ S)
Temperature comp.	500NTC, NONE
Accuracy & repeatability	$\pm 1.0\%$
Deadband/Setpoint	Programmable
Auto/Manual outputs	Menu selectable
Keypad	16 tactile push-buttons
Display	illuminated 128x64 pixel LCD
Drum Switch Inputs	2 digital contact inputs
Water meter inputs (2)	Contact head, paddle wheel, or turbine
Timers	Max. blowdown time exceeded and relay run time exceeded
Output Signal	One 4 – 20 mA, isolated or non-isolated optionally powered output for conductivity

Input Signal	One 4-20 mA, non- isolated internally powered input for conductivity
Output relays	4, 3 selectable use, 1 blowdown
Relay ratings	3A each, 10A total
Power	120/240 VAC 50/60 Hz
Ambient	32° - 120°F (0 - 49°C)
Enclosure	NEMA 4X, ETL



Sensors/Plumbing	Cooling Tower
Max Pressure	140 psi (9.65 bar)@ 100 °F
Max Temp	140°F (60°C)
Min flow	1 gpm (3.785 Lpm)

ORDERING OPTIONS

Controller Options

- 1229239** Model 1575e Conductivity Controller Only. (No Sensor or Plumbing).
- 1229240** Model 1575e Cooling Tower Water Treatment Conductivity Controller, Including Conductivity Sensor and Sensor Tee.
- 1229241** Model 1575e Cooling Tower Water Treatment Conductivity Controller, Including Conductivity Sensor and Left Exit Flowswitch Plumbing Assembly.
- 1230563** Model 1575e Cooling Tower Water Treatment Conductivity Controller, Including Conductivity Sensor and Flowswitch Plumbing Assembly.
- 1229242** Model 1575e Cooling Tower Water Treatment Conductivity Controller, Including Conductivity Sensor and Left Exit Flowswitch Plumbing Assembly on a Mounting Plate (12 X 21 in.).
- 1269417** Model 1575e Cooling Tower Water Treatment Conductivity Controller, Including Conductivity Sensor and Right Exit Flowswitch Plumbing Assembly on a Mounting Plate (12 X 21 in.).

Cooling Tower Options



1107003 Cooling Tower Flow Switch Plumbing



1167214 Cooling Tower Plumbing Tee



1167158 Cooling Tower sensor With 20 ft cable



PART # 1269417 with Right Exit Plumbing Assembly

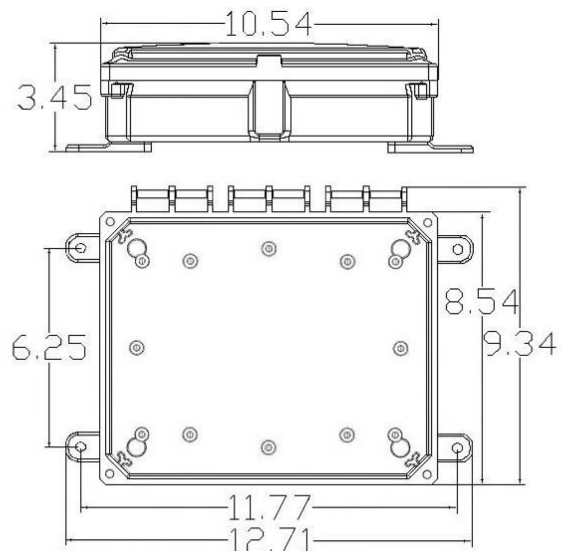

MODEL 1575e

PART NO.	CONDUCTIVITY COOLING TOWER CONTROLLER ONLY
----------	--

1229239	1575e controller only, no sensor or plumbing
---------	--

PART NO.	CONDUCTIVITY COOLING TOWER CONTROLLER SYSTEMS
----------	---

The Following Systems Include Sensor and Plumbing Assemblies

1229240	1575e with cooling tower sensor tee and sensor
1229241	1575e with cooling tower Left Exit flowswitch and sensor
1230563	1575e with cooling tower Right Exit flowswitch and sensor
1229242	1575e with cooling tower Left Exit FS and sensor on mounting plate
1269417	1575e with cooling tower Right Exit FS and sensor on mounting plate
1269338	1575e with cooling tower sensor, flow switch, and Trace Sensor Kit On a mounting plate

PART NO.	CONDUCTIVITY COOLING TOWER COMPONENTS	LIST	CD
----------	---------------------------------------	------	----

1167158	Sensor, Conductivity 2 elec w/20 ft Cable		
1167157	Sensor, Conductivity 2 elec w/2 ft Cable		
1169207	Sensor, Conductivity, 2 elec 4ft body w/20 ft cable		
1167214	Plumbing, tee, 3/4 inch NPT		
1107003	Plumbing, with 20' FS, remote plumbing Left Exit		
1230562	Plumbing, with 20' FS, remote plumbing Right Exit		
1269378	Kit, pH, Retrofit, includes isolation kit, pH sensor, and tee		
1269387	Kit, ORP, Retrofit, includes isolation kit, ORP sensor, and tee		

PART NO.	REPLACEMENT PARTS	LIST	CD
----------	-------------------	------	----

1269534	Kit, O-Ring, 1166418, for sensor and/or flow sight, set of 10		
1269533	Kit, Blue Ring replacement, 1169740, set of two		
1107004	Reed Switch w/20 ft of cable		
1167235	Reed Switch w/36 in. of cable for use with Mounting Plate		
1269596	Kit, Flow Sight, 1167266, set of five		
1269595	Kit, Flow Float, 1167234, set of five		
1107003	Plumbing, with 20' FS, remote plumbing Left Exit		
1230562	Plumbing, with 20' FS, remote plumbing Right Exit		
1269006	Lubricant Pack, Silicone, set of 20		